



Massachusetts Bay Transportation Authority

Lynn Improvements Program Interim Station Update

Recorded Project Overview

August 2023

Sharon Cranston, MBTA Project Manager

Agenda

- Interim Station Overview
- Interim Station Site Plan
- Construction Schedule
- What to expect during construction
- Service Alternatives
- Program Contact Information



Interim Station Overview

Project Purpose:

- The purpose of this project is to construct an Interim Station in Lynn that will restore service while the design and construction of the permanent station takes place

Project Benefits:

- Maintain Commuter Rail service for the Lynn community while the full reconstruction project at Lynn Station is ongoing

Interim Station Construction will be performed by Keolis:

- Anticipated Construction Start: Summer 2023
- Status: Mobilization



Interim Station: Overall Site Plan

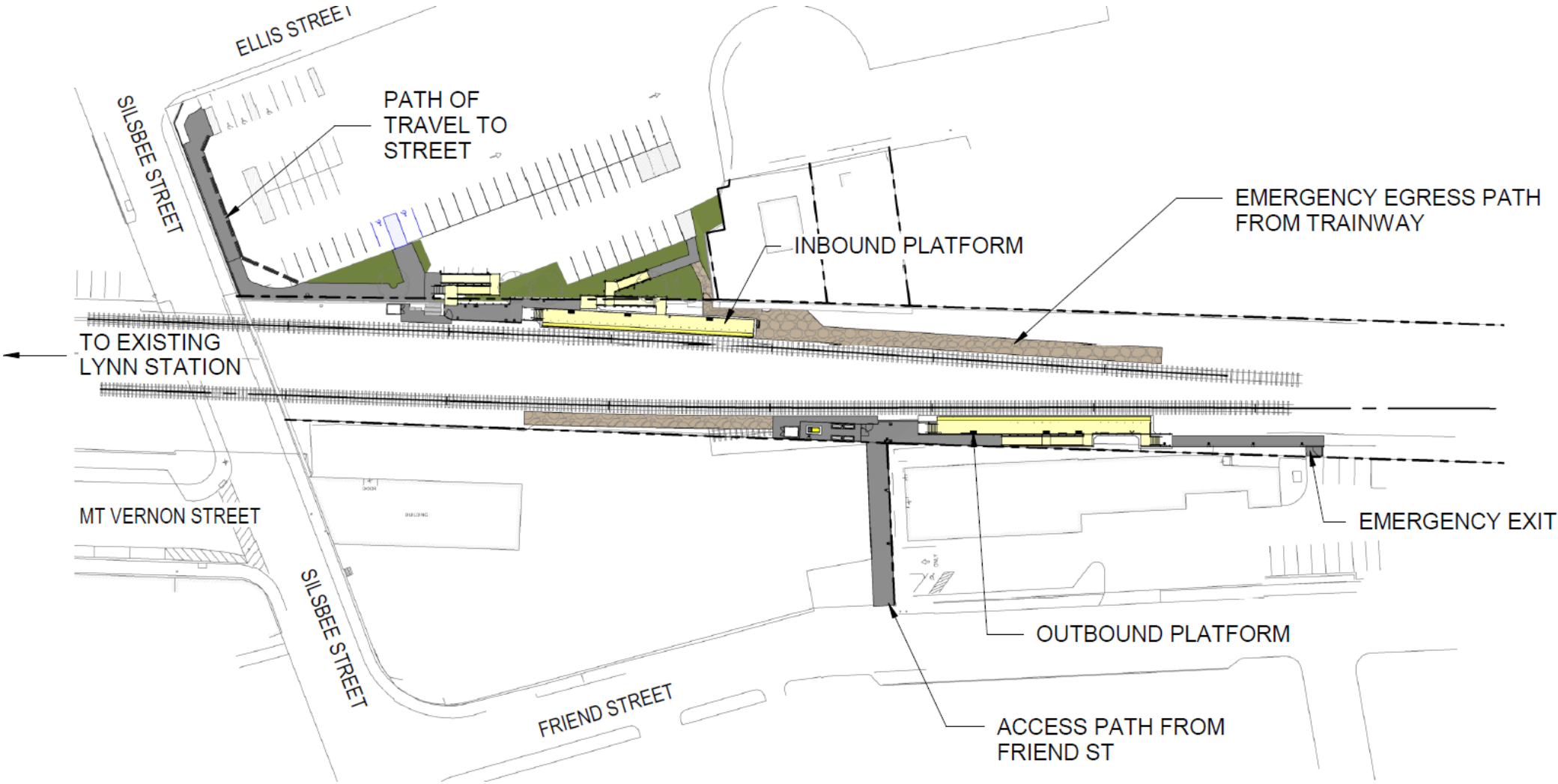

Interim Station: Inbound Platform Site Plan

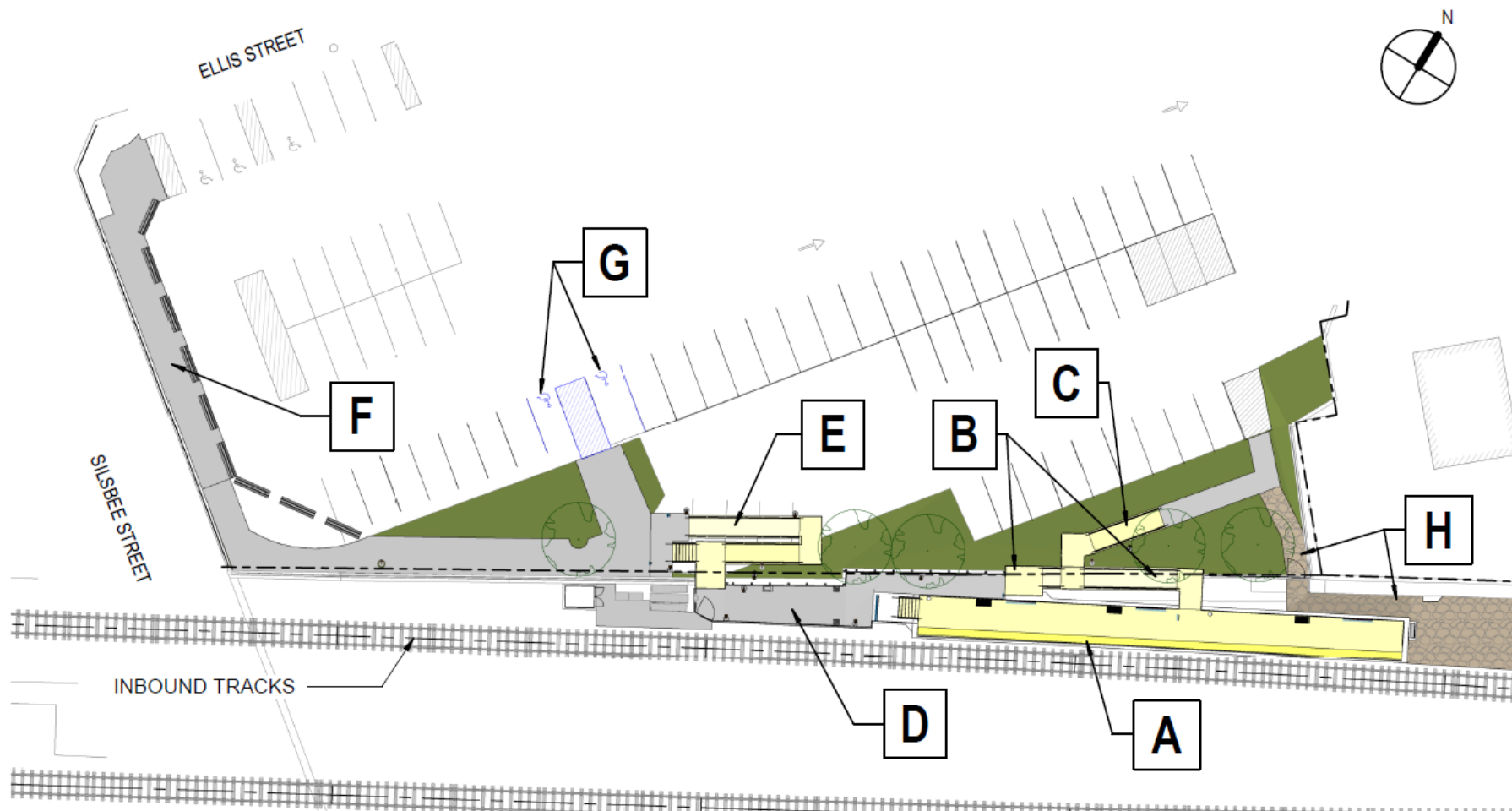

LEGEND:

- A. INBOUND PLATFORM
- B. ACCESS RAMP
- C. EMERGENCY EGRESS RAMP
- D. ENTRANCE PLAZA
- E. PLAZA ACCESS RAMP & STAIR
- F. ACCESSIBLE WALKWAY TO ELLIS ST.
- G. ADA PARKING SPACES
- H. EMERGENCY EGRESS FROM TRAINWAY



Interim Station: Outbound Platform Site Plan

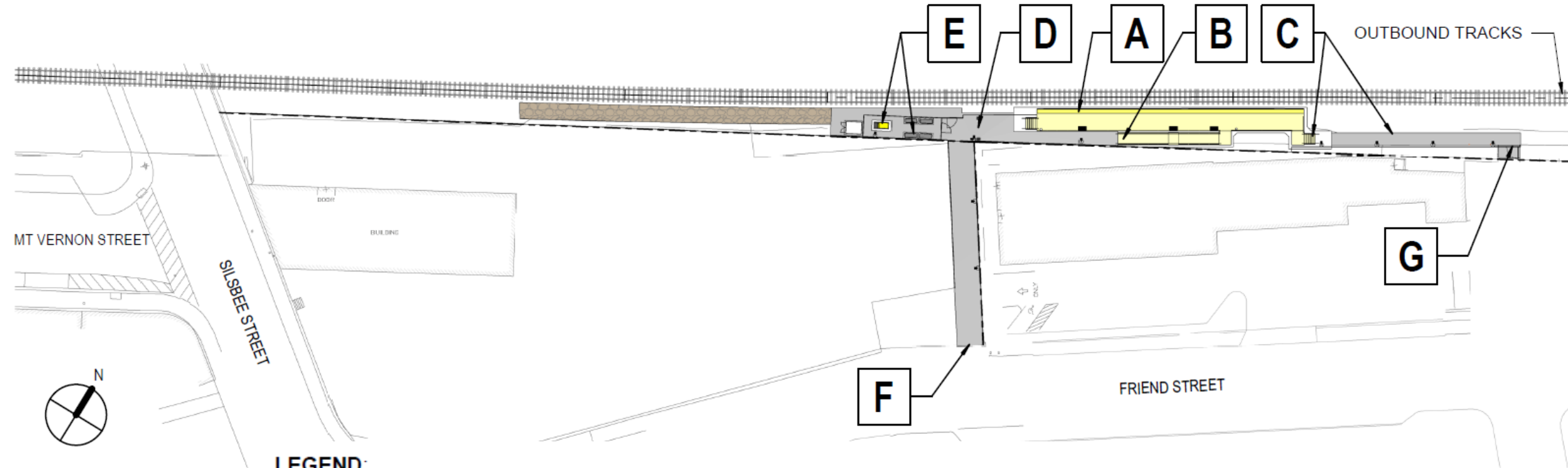

LEGEND:

- A. OUTBOUND PLATFORM
- B. ACCESS RAMP
- C. EMERGENCY EGRESS STAIR & WALKWAY
- D. ENTRANCE PLAZA

- E. GENERATOR & ELECTRICAL CABINETS
- F. WALKWAY TO FRIEND ST
- G. EMERGENCY EGRESS GATE IN FENCE



Construction Schedule

Activity	Schedule
Mobilization	August 2023
Construction Activities	September 2023 – April 2024
Anticipated Interim Station Opening	March 2024



What to Expect During Construction

- Neighbors can expect noise from construction activity, including heavy equipment and machinery
- Work will primarily take place during the day, Monday – Friday, 7am – 5pm
- Construction advisories will be distributed ahead of any scheduled night or weekend work, if necessary

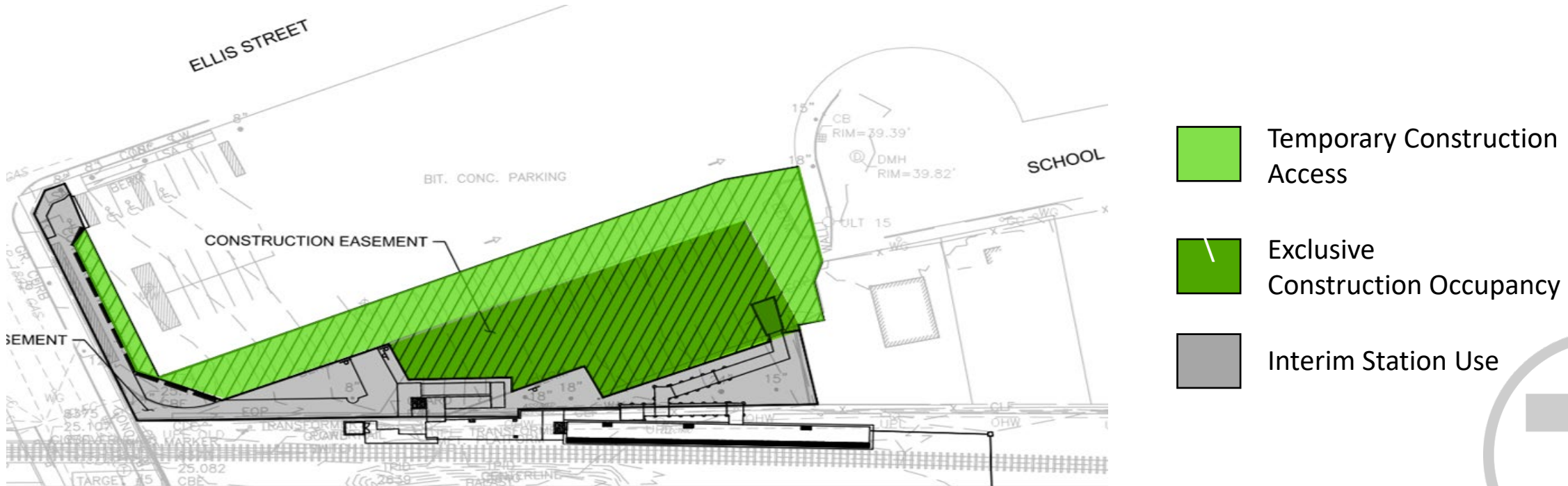

Service Alternatives

- **Shuttle busing** between Lynn and Swampscott Station will continue through the opening of the interim station construction.
 - From the North: Swampscott Station to the 455
 - From Boston: Blue Line at Wonderland Station to the 441, 442, or 455
 - From Chelsea: 117 from Bellingham Square to Wonderland Station to the 441, 442, or 455
 - 426 Express Service between Lynn Central Square and Haymarket
- **Lynn Ferry** will provide service between Blossom Street Pier and Long Wharf

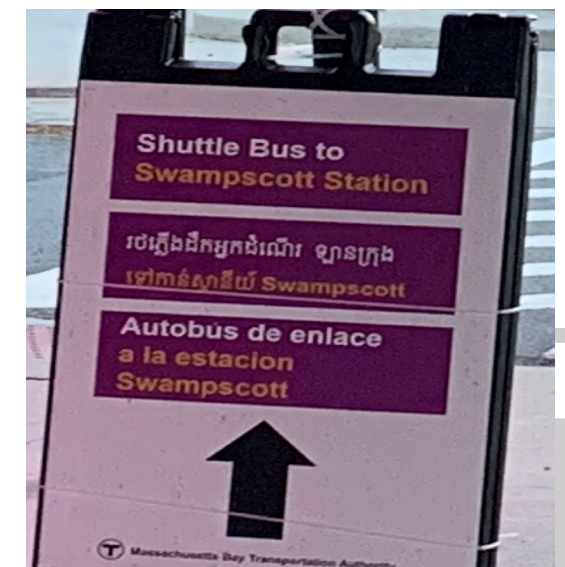
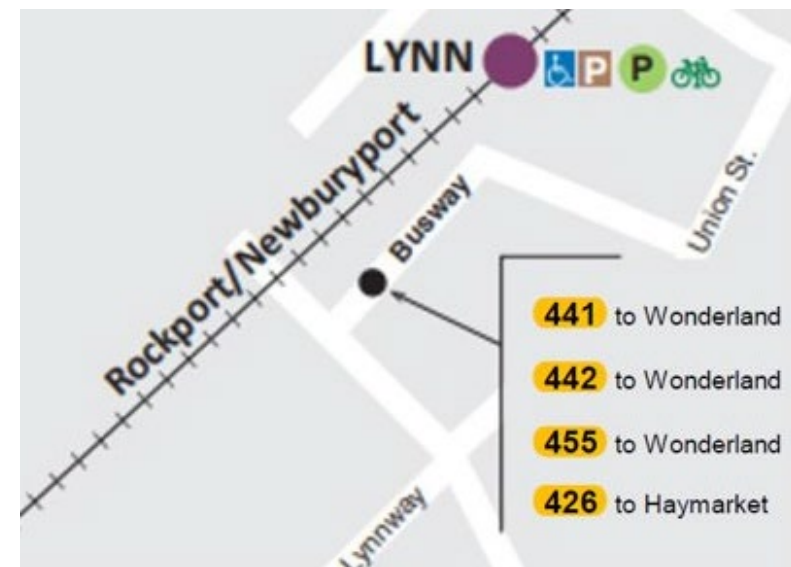

Program Contact

Visit the Program Website

www.mbta.com/LynnStation

Public and Stakeholders can sign up for email updates from program on website

Program Email

LynnStation@mbta.com

