

**Massachusetts Bay
Transportation Authority**

North Station Draw One Bridge Replacement

Project Overview

Spring 2023

Capital Delivery Bridge/Structures Program

Agenda

- A. Program Overview
- B. Existing Conditions
- C. Proposed Improvements
- D. Next Steps
- E. Project Contact



Draw One Improvements Overview

Overview:

- Modernization of the North Station Draw One Bridge and the Control Tower A
- Design contract awarded to STV in 2019 for \$45 million
- Status: 75% Design Complete

Objectives:

- Replace North Station Draw One Bridge
- Replace Control Tower A
- Track and signal upgrades
- Improve safety, reliability, and overall customer experience

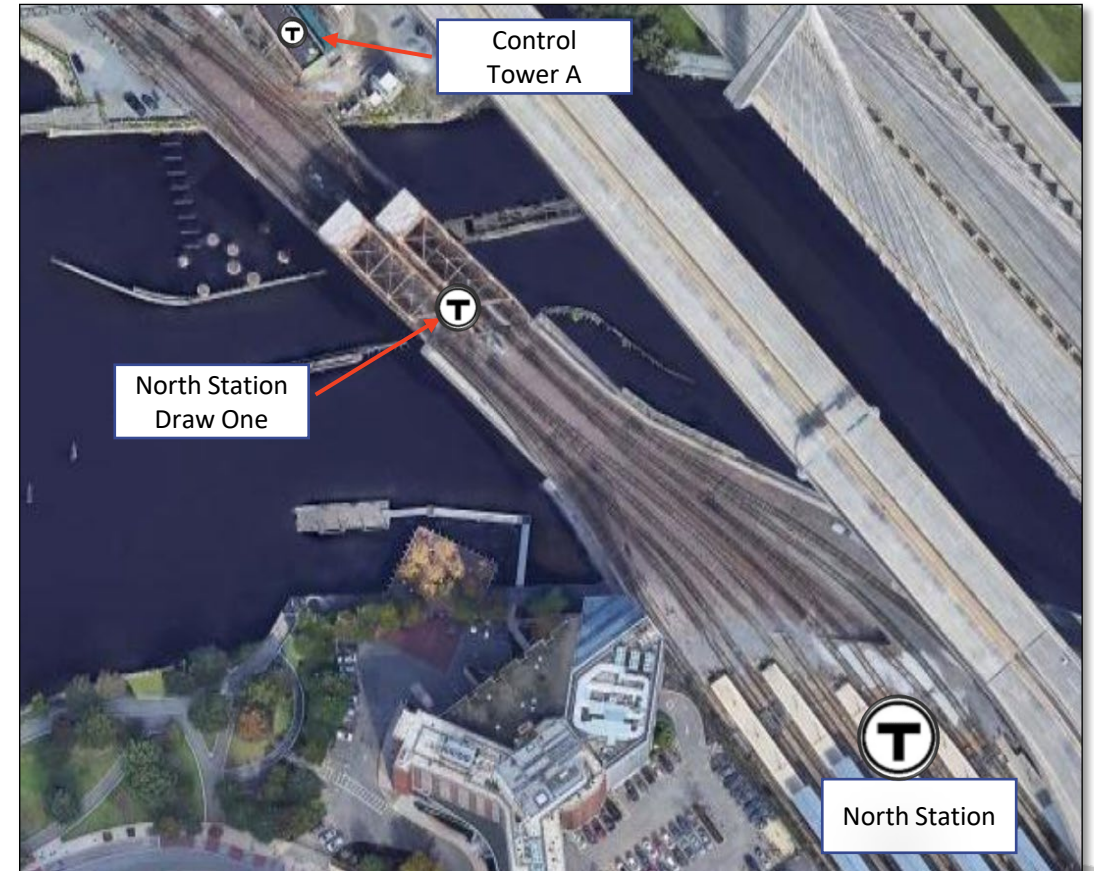

Existing Conditions: Draw One



View of existing bridge looking toward Zakim Bridge



View of outbound train crossing Draw One Bridge



Picture of Bridge Caisson showing deterioration



Existing Conditions: Track and Signal



Several types of fasteners are often intermixed throughout the terminal area



Typical existing signal on Draw One



Existing Conditions: Control Tower A



Existing Control Tower A building, currently out of service



Severely cracked and displaced brickwork



Bent and damaged copper flashing

Proposed Improvements: Draw One

- Upgrade of the two existing current two moveable spans
- Restoration of the third moveable span
- Extension of an existing platform at North Station to connect station tracks 11 and 12 to the existing network
- Upgrade of tracks approaching both sides of the bridge



Proposed Improvements: Track and Signal

- Rehabilitation and extension of existing Platform F (Tracks 11 and 12) at North Station
- Connection of Tracks 11 and 12 to the rail network
- Track improvements extending 1.5 miles from North Station
- Upgrades to signal control system



Proposed Improvements: Control Tower A

- Construction of the new Control Tower A building
- House all rail operations and maintenance components
- Provides operational control of Draw One bridge

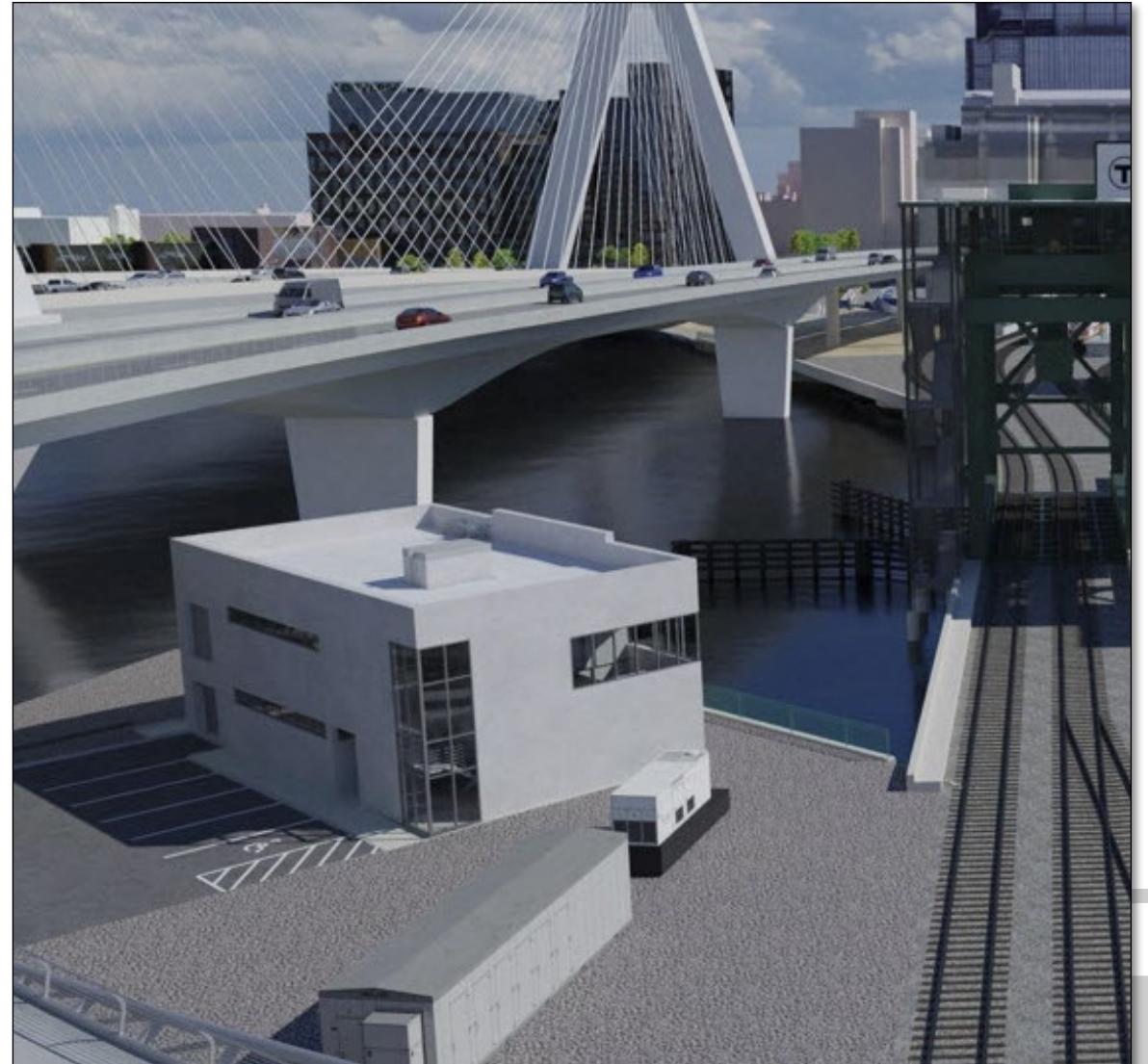

Next Steps

- Continue Project Design
- Environmental Review and Permitting in Progress
- Anticipate Reaching 100% Design in 2024
- Identify Construction Funding



Project Contact

Visit the Project Website:
www.mbta.com/DrawOne

For more information, public and stakeholders can contact the project via the project email:
DrawOne@mbta.com

